

Intermittent Motion Traypacker FlexiPro Traypacker



Key Features

- Ergonomic design for operator interface
- Low profile magazine for easier loading
- Speeds up to 20 trays per minute
- Allen-Bradley PanelView HMI
- Full-length access doors
- Nordson hot melt glue system
- Allen-Bradley Logix series PLC
- VFD-controlled main drive

Intermittent Motion Traypacker

FlexiPro Traypacker

Thiele's FlexiPro Traypacker is a fully automatic tray packaging system designed to end-load a variety of products into corrugate trays. When paired with a Thiele integral loader and infeed system, the FlexiPro automatically feeds a corrugate blank, loads it, and closes and seals the flaps in preparation for shrink bundling or palletizing.

Designed for quiet, low-maintenance operation, the FlexiPro features a Venturi vacuum system that ensures positive placement of the tray blank.

Thiele's FlexiPro Traypacker is a fully automatic tray packaging system designed to end-load a variety of products into corrugate trays. When paired with a Thiele integral loader and infeed system, the FlexiPro automatically feeds a corrugate blank, loads it, and closes and seals the flaps in preparation for shrink bundling or palletizing.

Designed for quiet, low-maintenance operation, the FlexiPro features a Venturi vacuum system that ensures positive placement of the tray blank.

Optional Features

- Servo main drive
- Low level tray detection
- Beacon light to indicate traypacker operation
- Open flap detection
- Additional magazine length
- Ethernet interface
- UL-listed electrical enclosure
- Digital indicators and calibrated scales

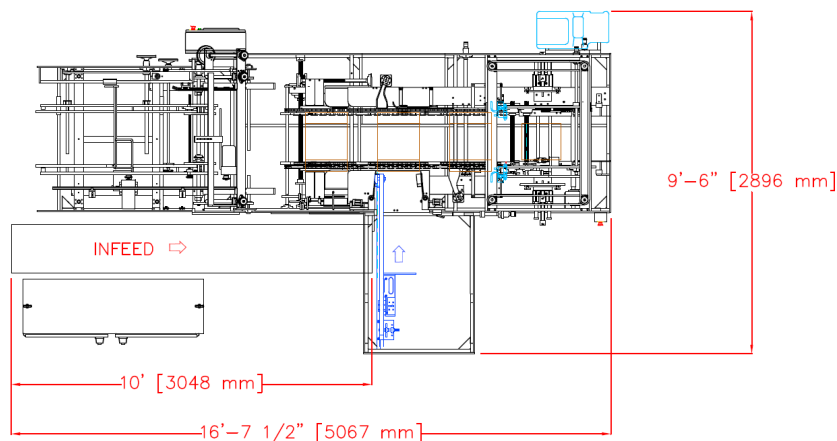

All sales are subject to our prevailing terms and conditions. Illustrations and specifications are subject to change without notice. Machines shown without guards are for illustrative purposes only. Guards are supplied and must be in place before operation.

Specifications		
Speed		
Up to 20 trays per minute; final speed dependent on product and product orientation		
Tray Size Range	Minimum	Maximum
Length	8"	15"
Height*	5"	12"
Width	8"	9"
Electrical Requirements		
Incoming Voltage	240/480 volts, 3 phase, 60 Hz	
Control Voltage	24 VDC	
Hot Melt Circuit	240 volt, 60 hertz, 1 to 3 phase (optional transformer available if incoming voltage is other than 240)	
Current Draw	Dependent on machine configuration	
Air Requirements		
Operating Pressure	80 psi	
Line Pressure	90 psi	
Maximum Free Air Consumption	1.24 cu ft per cycle	
Hot Melt Air Pressure	20 to 60 psi	