

FlexiPro Wraparound Casepacker



Standard Features

- Ergonomic design for operator interface
- Low profile magazine for easier loading
- Digital indicators and calibrated scales
- Walk-in area for improved access
- Speeds up to 20 cases per minute
- Venturi vacuum source
- 10" color touch-screen with diagnostic alarms
- 24 VDC control voltage
- Full-length access doors
- Nordson ProBlue hot melt system
- Allen-Bradley Logix series controller
- Inside manufacturer's joint
- VFD-controlled main drive



Barry-Wehmiller

FlexiPro Wraparound Casepacker

Thiele's FlexiPro Wraparound Casepacker is a fully automatic case packaging system designed to end-load a variety of products into wraparound cases. When paired with a Thiele loader and infeed system, the FlexiPro automatically feeds a corrugated blank, erects it, positions the case for loading, and closes and seals the flaps in preparation for palletizing.

Designed for quiet, low-maintenance operation, the FlexiPro features a Venturi vacuum system that ensures positive placement of the wraparound blank.

Mechanical case feeding of this four-station casepacker guarantees positive control of the case throughout the loading, flap folding, and sealing processes. Additionally, although the FlexiPro is designed for maximum versatility, no change parts are required in the case handling area of the system.

Thiele offers a wide variety of loader, accumulation, and infeed solutions for any case packaging application.

Specifications		
PRODUCTION SPEED		ELECTRICAL REQUIREMENTS
Up to 20 cases per minute. Final speed is dependent on product and product orientation.		Incoming Voltage 240/480 volts, 3 phase, 60 hertz
		Control Voltage 24 VDC
		Hot Melt Circuit 240 volt, 60 hertz, 1 to 3 phase (optional transformer is available if incoming voltage is other than 240)
		Current Draw Dependent on loader
CASE SIZE RANGE		AIR REQUIREMENTS
	Minimum	Maximum
Length	8"	15"
Width	5"	12"
Depth	8"	20"
		Operating Pressure 80 psi
		Line Pressure 90 psi
		Maximum Free Air Consumption 1.24 cu. ft. per cycle
		Hot Melt Air Pressure 20 to 60 psi

Optional Features

- Servo main drive
- Tray packing
- Low level case detection
- Beacon lights to indicate case packer operation
- Open flap detection
- Length of magazine
- Outside manufacturer's joint
- Additional magazine length
- Ethernet interface

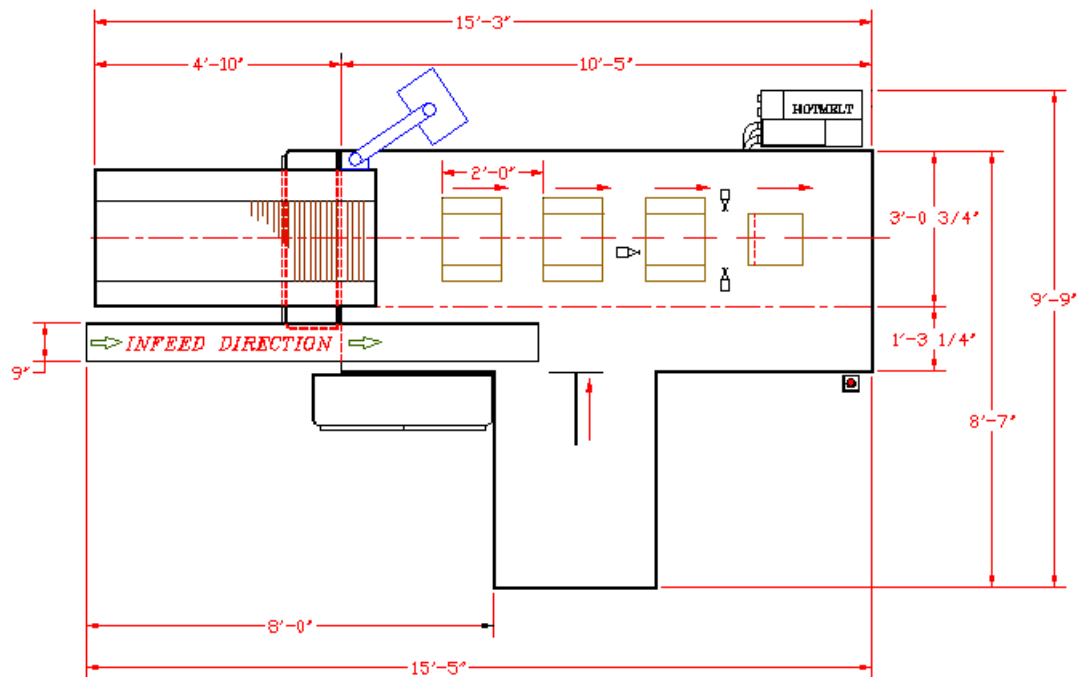

All sales are subject to our prevailing terms and conditions. Illustrations and specifications are subject to change without notice. Machines shown without guards are for illustrative purposes only. Guards are supplied and must be in place before operation.

Thiele Technologies, Inc.

HQ - Minneapolis, MN • Fergus Falls, MN • Fridley, MN • Reedley, CA
612/782-1200 218/739-3321 763/502-0000 559/638-8484

www.thieletech.com • sales@thieletech.com